



**Apply today!**

ONE PHONE CALL  
ONE APPLICATION  
NO APPLICATION FEE  
Call **667-600-2280**



CATHOLIC CHARITIES  
SENIOR COMMUNITIES

2300 Dulaney Valley Road  
Timonium, MD 21093

**667-600-2280**

**TTY: Dial 711**

**Toll-free 1-888-710-9868**

**email: [housing@cc-md.org](mailto:housing@cc-md.org)**

**[www.cc-md.org/senior-communities](http://www.cc-md.org/senior-communities)**

*Inspired by the Gospel mandates to love, serve and teach, Catholic Charities provides care and services to improve the lives of Marylanders in need.*



Catholic Charities welcomes people regardless of faith and is an Equal Housing Opportunity provider.



CATHOLIC  
CHARITIES  
SENIOR  
COMMUNITIES

**SMOKE  
FREE in  
2019**

*Exceptional, affordable  
apartment communities  
for older adults.*

CATHOLIC CHARITIES  
SENIOR COMMUNITIES

**MISSION** in **ACTION**

Catholic Charities Senior Communities develops and operates affordable, **SUPPORTIVE** communities for older adults with a resolve to **NURTURE** a **SPIRIT** of **PURPOSE**, **WELLNESS** and **HARMONY** among both our **RESIDENTS** and **COLLEAGUES**.

Catholic Charities owns and operates 24 affordable senior apartment communities in Baltimore City and Anne Arundel, Baltimore, Garrett and Harford Counties.

We offer over 1,800 apartments including efficiencies, one- and two-bedroom units. Catholic Charities has been a leader in providing quality, service-enriched, affordable apartment communities for over 35 years.

### **Making a Difference**

We have been recognized, both in Maryland and nationally, for our commitment, exceptional services and quality communities.

Our employees live the Catholic Charities mission, vision and values to love, serve, teach and work for justice.

In a recent survey of Catholic Charities Senior Communities' residents, 93% of respondents stated they are satisfied with their quality of life and their community and are likely to recommend it to a friend or family member.

### **Welcome Home**

Enjoy these amenities at each of our communities:

- Electronically controlled access and secured entry
- Personal emergency response systems
- Large, well-appointed community gathering spaces
- Spacious, modern laundry rooms and lounges
- Resident computer centers
- Landscaped gardens and outdoor spaces
- Small pets are welcomed

*"The staff is very caring and sensitive to my needs. They make my living here comfortable and happy."*







## Services

Our resident **service coordinators** are available at all of our communities to assist residents in accessing various resources and benefits to help with finances, health care and transportation, to name a few.

The **Support Services Program** (Congregate Housing Services Program of the Maryland Department of Aging), available at nine of our communities, provides weekly housekeeping, laundry and personal services as well as daily meals to those residents who need a helping hand. (See listing of locations marked with \*)

**Health care services** available to residents in our communities include podiatry and monthly blood pressure checks. Additional services may include phlebotomy, mental health and primary care.

*"I would highly recommend my community to others because I feel safe. It's a relaxing atmosphere."*

## Anne Arundel County

**Arundel Woods \***  
72 1-Bedroom Units  
403 W. Ordnance Road  
Glen Burnie, MD 21061  
667-600-3160

**Friendship Station \***  
88 1-Bedroom Units  
1212 Odenton Road  
Odenton, MD 21113  
667-600-3370

**Friendship Village**  
63 1-Bedroom Units  
1208 Odenton Road  
Odenton, MD 21113  
667-600-3380

## Baltimore City

**Basilica Place \***  
200 1- & 2-Bedroom Units  
124 W. Franklin Street  
Baltimore, MD 21201  
667-600-3300

**DePaul House \***  
109 1- & 2-Bedroom Units  
3300 Benson Avenue  
Violetville, MD 21227  
667-600-2684

**Everall Gardens ♦**  
69 1-Bedroom Units  
6100 Everall Avenue  
Overlea, MD 21206  
667-600-2395

**Our Lady of Fatima I**  
54 1-Bedroom Units  
6424 East Pratt Street  
Baltimore, MD 21224  
667-600-3301

**Our Lady of Fatima II**  
51 1-Bedroom Units  
200 Kane Street  
Baltimore, MD 21224  
667-600-3301

**St. Joachim House \***  
90 1-Bedroom Units  
3310 Benson Avenue  
Violetville, MD 21227  
667-600-2685

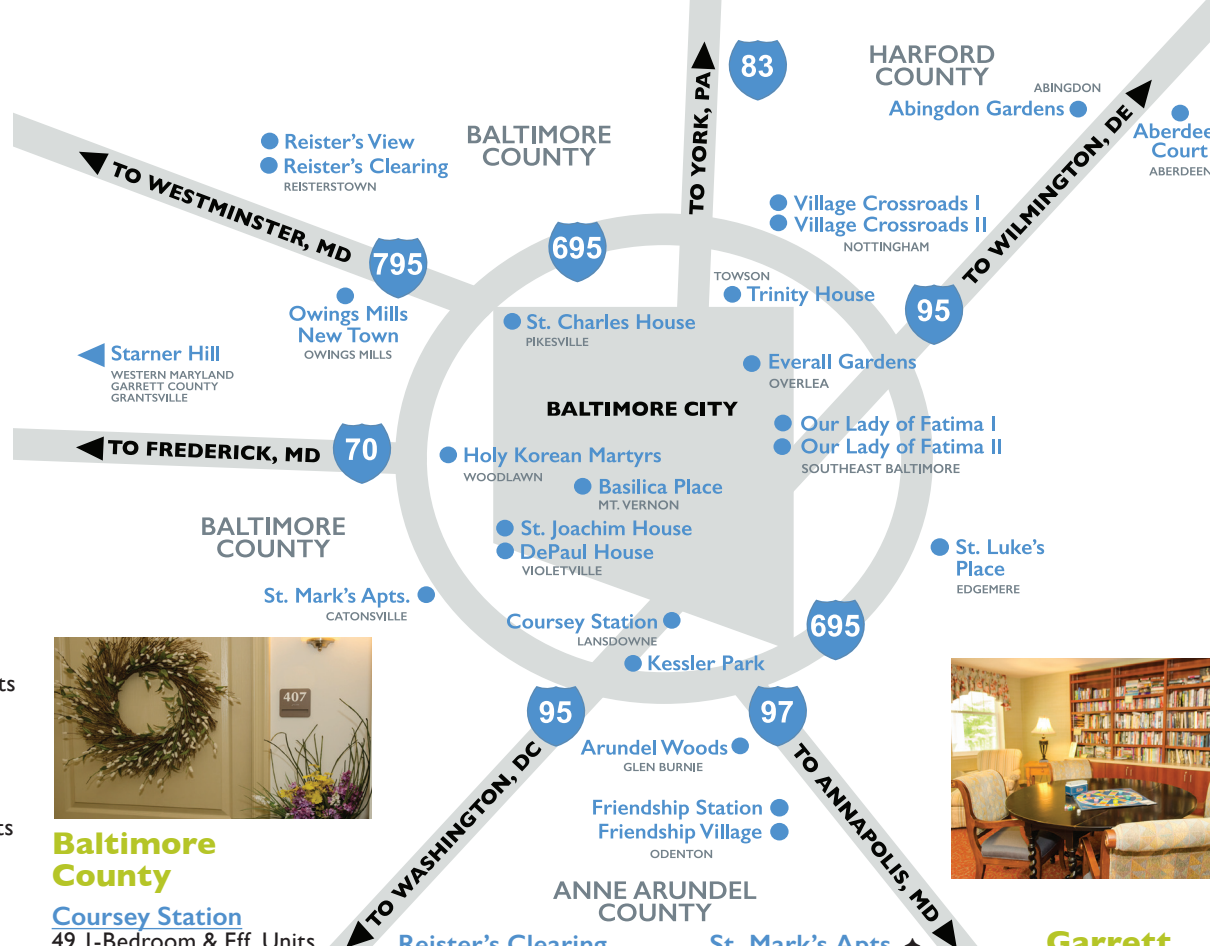

## Baltimore County

**Coursey Station**  
49 1-Bedroom & Eff. Units  
200 First Avenue  
Lansdowne, MD 21227  
667-600-3155

**Holy Korean Martyrs**  
74 1-Bedroom Units  
5500 Lexington Road  
Woodlawn, MD 21207  
667-600-3150

**Kessler Park ♦**  
64 1- & 2-Bedroom Units  
4230 Hollins Ferry Road  
Lansdowne, MD 21227  
667-600-3670

**Owings Mills New Town**  
68 1-Bedroom Units  
9773 Groffs Mill Drive  
Owings Mills, MD 21117  
667-600-3180

**Reister's Clearing**  
68 1-Bedroom Units  
304 Cantata Court  
Reisterstown, MD 21136  
667-600-2180

**Reister's View**  
72 1-Bedroom Units  
306 Cantata Court  
Reisterstown, MD 21136  
667-600-2190

**St. Charles House**  
24 1-Bedroom & Eff. Units  
11 Church Lane  
Pikesville, MD 21208  
667-600-3185

**St. Luke's Place \***  
125 1-Bedroom Units  
2825 Lodge Farm Road  
Edgemere, MD 21219  
667-600-3661

**St. Mark's Apts. ♦**  
20 1-Bedroom Units  
19 Winters Lane  
Catonsville, MD 21228  
667-600-3675

**Trinity House \***  
82 1-Bedroom Units  
409 Virginia Avenue  
Towson, MD 21286  
667-600-3733

**Village Crossroads I ♦♦**  
94 1-Bedroom Units  
4313-A Fitch Avenue  
Nottingham, MD 21236  
667-600-2360

**Village Crossroads II**  
86 1-Bedroom Units  
4313-B Fitch Avenue  
Nottingham, MD 21236  
667-600-2370

## Harford County

Abingdon Gardens

Abingdon

Aberdeen Court  
Aberdeen

**Typical Layout**  
One Bedroom Apartment  
Approximately 540 square feet

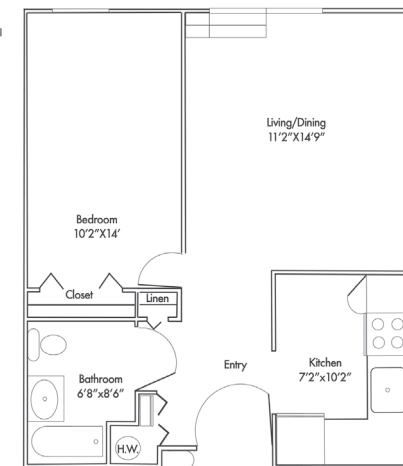

*"Catholic Charities is a gift. Living here has proven to be a blessing for me. I have now found peace of mind."*



## Garrett County

**Starnier Hill**  
18 1-Bedroom & Eff. Units  
25 N. Pennsylvania Avenue  
Grantsville, MD 21536  
301-895-5842

## Harford County

**Aberdeen Court \***  
75 1-Bedroom Units  
901 Barnett Lane  
Aberdeen, MD 21001  
667-600-2175

**Abingdon Gardens**  
76 1-Bedroom Units  
3001 St. Clair Drive  
Abingdon, MD 21009  
667-600-2170

\* Support Services Program See explanation under Services on the left side of this page.

♦ Tax Credit Community (Village Crossroads I offers some tax credit units.)